

# MVC610NIR

## 1/3" Day/Night Color CCD Camera



Equipped with day/night capabilities and audio, the MVC610NIR is built for mobile applications and designed to withstand the rigorous conditions of mass transit and law enforcement environments. With built-in infrared illuminations and integrated audio (optional) you can see as well as hear what is behind your vehicle.

### Special Features

- 1/3" Sony SuperHAD CCD ExView
- 520 TVL for excellent picture quality
- LED lighting distance up to 10 meters
- Designed for continuous 24/7 surveillance
- Auto White Balance and AGC
- Full Three Year Warranty

### Specifications

Image Sensor	1/3" Sony HyperHAD ExView CCD
Effective Pixel	768 (H) x 494 (V)
TV System	NTSC: 280K x 410K PAL: 320K x 470K
Lens	Fixed (f2.5mm / f3.6mm)
Resolution	Up to 520 TV Lines
Sync System	Internal
Minimum Illumination	0 Lux with IR LED up to 10m (850nm) Up to 5m (940nm)
S/N Ratio	More than 48 dB (AGC off)
Shutter Speed	NTSC: 1/60 - 100,000 sec PAL: 1/50 - 100,000 sec
Gain	Auto, Manual .3 to 28dB
Power	10V DC - 14V (recommended DC 12+/-0.5V)
White Balance	Auto
AGC	Auto

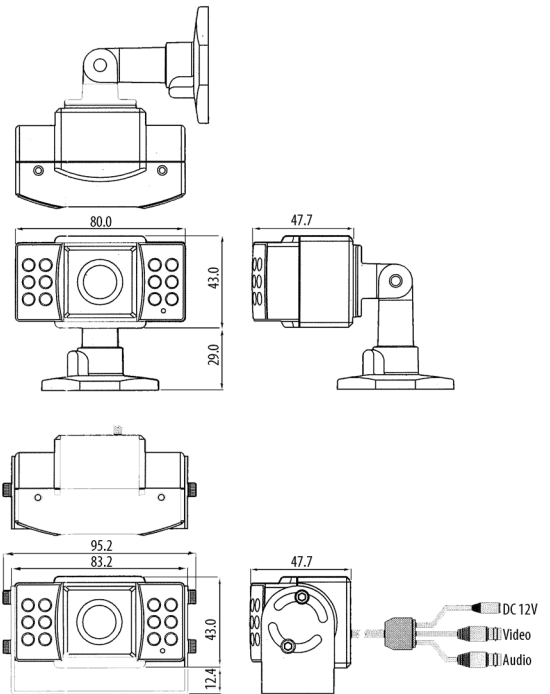

**Fleet Management, Inc.**  
2545 Valley Ridge Drive • Cumming, GA 30040  
(770) 263-8118 • Fax (770) 887-5944  
[www.PoliceVideoCameras.com](http://www.PoliceVideoCameras.com) • [sales@PoliceVideoCameras.com](mailto:sales@PoliceVideoCameras.com)

**MOBILEVIDEO**  
SYSTEMS LLC